

B3

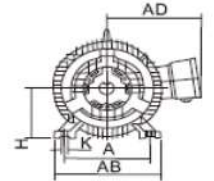

B5

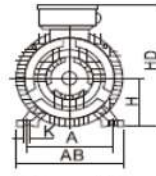
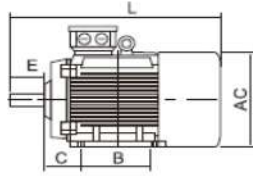
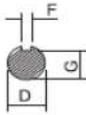
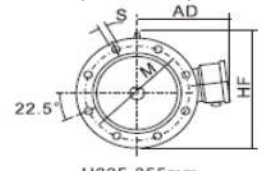
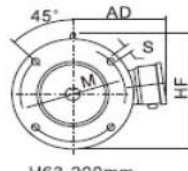
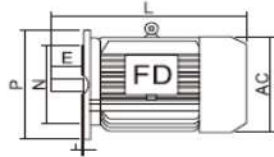

H63-200mm

H225-355mm

机座号 Frame	极数 Pole	安装尺寸 Mounting Dimension											外形尺寸 Overall Dimension									
		A	B	C	D	E	F	G	H	M	N	P	R	S	T	K	AB	AC	AD	HD	HF	L
63M	2.4	100	80	40	11	23	4	8.5	63	115	95	140	0	10	3	7	135	130	70	180	130	230
71M	2.4.6	112	90	45	14	30	5	11	71	130	110	160	0	10	3.5	7	150	145	80	195	145	255
80M	2.4.6.8	125	100	50	19	40	6	15.5	80	165	130	200	0	12	3.5	10	165	175	145	220	185	295
90S	2.4.6.8	140	100	56	24	50	8	20	90	165	130	200	0	12	3.5	10	180	195	155	250	195	320
90L	2.4.6.8	140	125	56	24	50	8	20	90	165	130	200	0	12	3.5	10	180	195	155	250	195	345
100L	2.4.6.8	160	140	63	28	60	8	24	100	215	180	250	0	15	4	12	205	215	180	270	245	385
112M	2.4.6.8	190	140	70	28	60	8	24	112	215	180	250	0	15	4	12	230	240	190	300	265	400
132S	2.4.6.8	216	140	89	38	80	10	33	132	265	230	300	0	15	4	12	270	275	210	345	315	470
132M	2.4.6.8	216	178	89	38	80	10	33	132	265	230	300	0	15	4	12	270	275	210	345	315	510
160M	2.4.6.8	254	210	108	42	110	12	37	160	300	250	350	0	19	5	15	320	330	255	420	385	615
160L	2.4.6.8	254	254	108	42	110	12	37	160	300	250	350	0	19	5	15	320	330	255	420	385	670
180M	2.4.6.8	279	241	121	48	110	14	42.5	180	300	250	350	0	19	5	15	355	380	280	455	430	700
180L	2.4.6.8	279	279	121	48	110	14	42.5	180	300	250	350	0	19	5	15	355	380	280	455	430	740
200L	2.4.6.8	318	305	133	55	110	16	49	200	350	300	400	0	19	5	19	395	420	305	505	480	770
225S	4.8	356	286	149	60	140	18	53	225	400	350	450	0	19	5	19	435	470	335	560	535	815
225M	2	356	311	149	55	110	16	49	225	400	350	450	0	19	5	19	435	470	335	560	535	820
	4.6.8				60	140	18	53														845
250M	2	406	349	168	60	140	18	53	250	500	450	550	0	19	5	24	490	510	370	615	595	910
	4.6.8				65	140	18	58														
280S	2	457	368	190	65	140	18	58	280	500	450	550	0	19	5	24	550	580	410	680	650	985
	4.6.8				75	140	20	67.5														
280M	2	457	419	190	65	140	18	58	280	500	450	550	0	24	5	19	550	580	410	680	650	1035
	4.6.8.10				75	140	20	67.5														
315S	2	508	406	216	65	140	18	58	315	600	550	660	0	24	6	28	635	645	530	845	—	1160
	4.6.8.10				80	170	22	71													1270	
315M	2	508	457	216	65	140	18	58	315	600	550	660	0	24	6	28	635	645	530	845	—	1190
	4.6.8.10				80	170	22	71													1300	
315L	2	508	508	216	65	140	18	58	315	600	550	660	0	24	6	28	635	645	530	845	—	1190
	4.6.8.10				80	170	22	71													1300	
355M	2	610	560	254	75	140	20	67.5	355	740	680	800	0	24	6	28	730	710	655	1010	—	1500
	4.6.8.10				95	170	25	86													1530	